

Secondary Valve Body

Disassembly/Inspection/Reassembly

NOTE:

- Clean all parts thoroughly in solvent or carburetor cleaner and dry with compressed air.
- Blow out all passages.
- Replace valve body as an assembly if any parts are worn or damaged.
- Check all valves for free movement. If any fail to slide freely, see Valve Body Repair on page 14-75.
- Coat all parts with ATF before reassembly.

CAUTION: Do not use a magnet to remove the check balls; it may magnetize the balls.

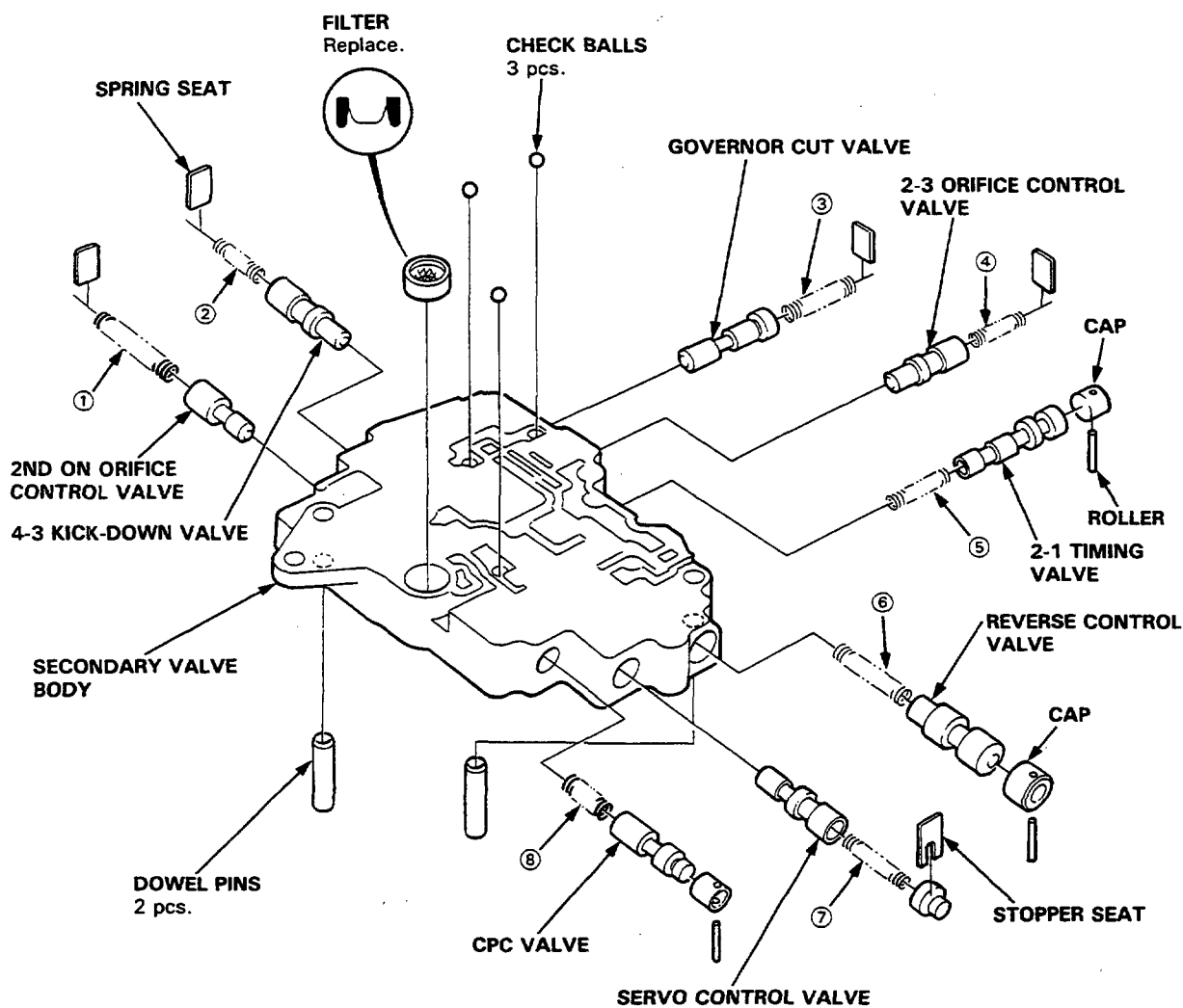

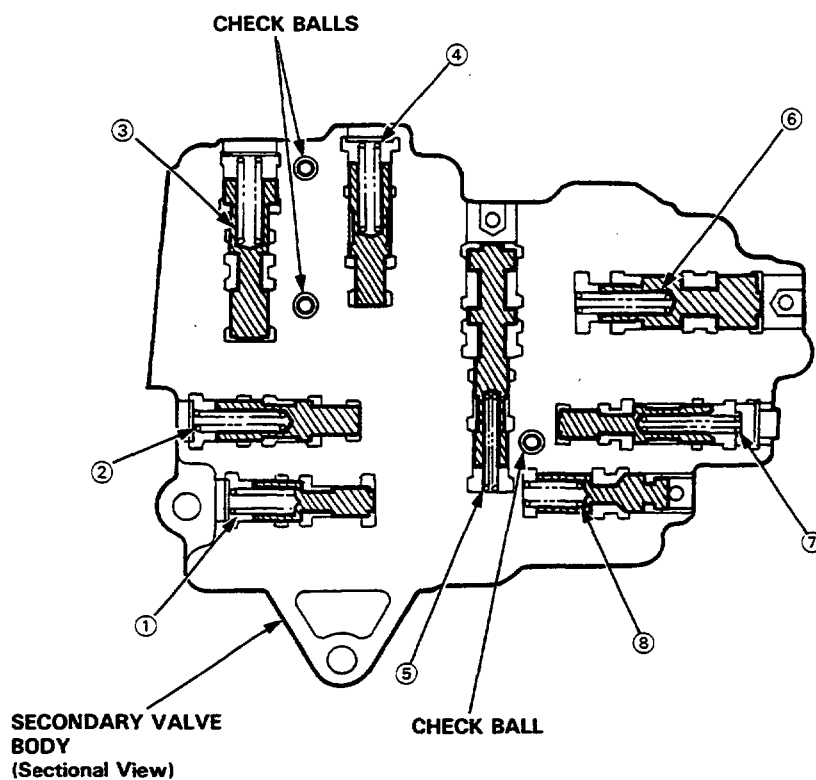

SPRING SPECIFICATIONS

Unit of length: mm (in)

No.	Spring	Standard (New)			
		Wire Dia.	O.D.	Free Length	No. of Coils
①	2nd ON orifice control valve spring	0.9 (0.035)	8.0 (0.315)	24.1 (0.949)	9.6
②	4-3 kick-down valve spring	1.0 (0.039)	6.6 (0.260)	29.9 (1.177)	14.7
③	Governor cut valve spring	0.8 (0.031)	7.6 (0.299)	44.5 (1.752)	17.0
④	2-3 orifice control valve spring	0.9 (0.035)	6.6 (0.260)	33.2 (1.307)	14.9
⑤	2-1 timing valve spring	0.7 (0.028)	5.6 (0.220)	33.0 (1.299)	21.7
⑥	Reverse control valve spring	0.7 (0.028)	7.1 (0.280)	40.0 (1.575)	20.8
⑦	Servo control valve spring	0.9 (0.035)	6.4 (0.252)	34.1 (1.343)	17.5
⑧	CPC (Clutch Pressure Control) valve spring	0.9 (0.035)	8.4 (0.331)	24.9 (0.980)	9.8